

- NOTES:
1. THIS DRAWING IS FOR PLANNING APPLICATION PURPOSES ONLY.
 2. DRAWING NOT TO BE SCALED. FIGURED DIMENSIONS ONLY TO BE USED.
 3. ALL LEVELS TO MALIN HEAD METRES ABOVE DATUM.
 4. DETAILS OF SLAB CONSTRUCTION MAY VARY AND IS SUBJECT TO FURTHER SITE INVESTIGATION AND DETAILED DESIGN.
 5. REFER TO DRG. NO. QS-000206-01-D460-071 FOR LOCATION OF SLAB B SECTION THROUGH STOCKPILE.

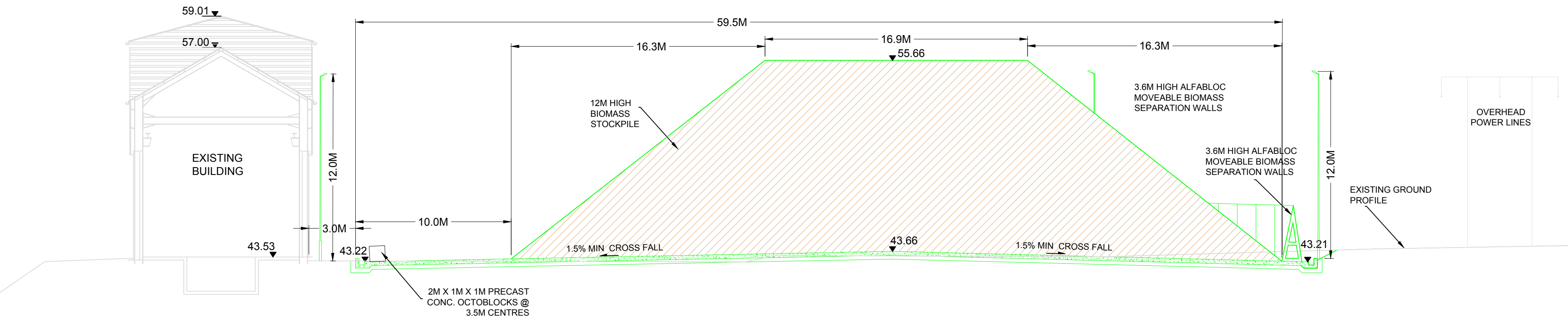

**BIOMASS STORAGE SLAB B
SECTION A-A**

SCALE 1:200
(SEE DRG. QS-000206-01-D460-033)

LEGEND

PROPOSED WORKS	—
EXISTING BUILDINGS	—
PROPOSED BIOMASS STOCKPILE	▨
PROPOSED LEVELS	43.16
EXISTING LEVELS	43.16

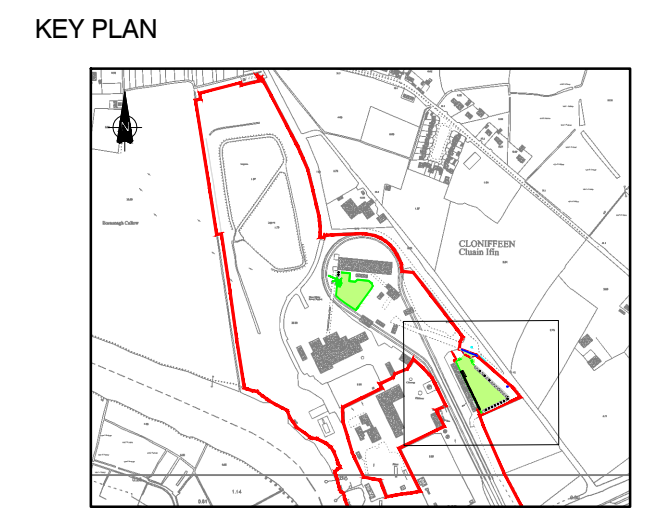

REFERENCE: OSI MAP NO: OY013-10

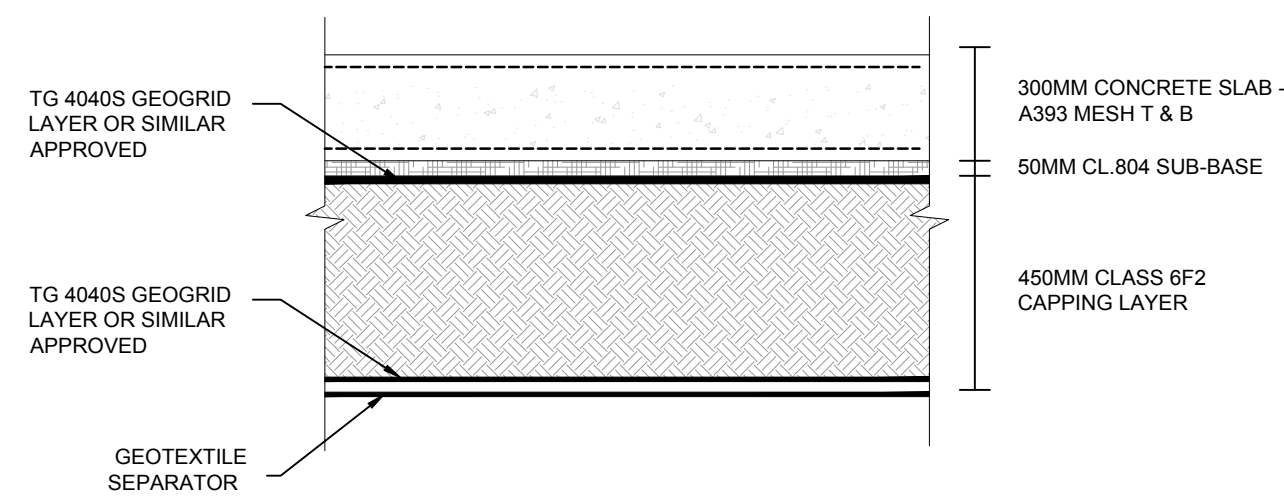

BIOMASS STORAGE SLAB - TYPICAL SECTION SHOWING BUILD UP
NOTE: SUBJECT TO DETAILED DESIGN
SCALE 1:25 (A1)

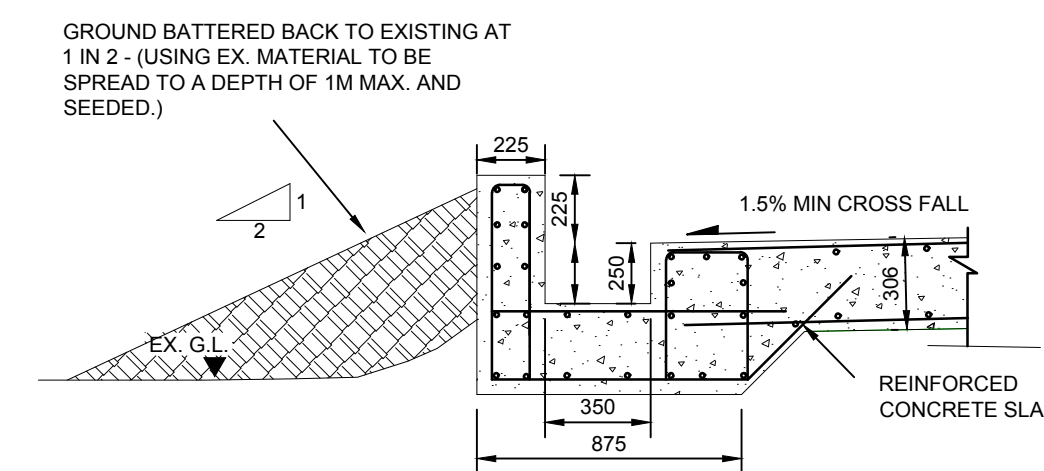

BIOMASS STORAGE SLAB B OPEN CHANNEL DETAIL (TYP)
SCALE 1:25 (A1)

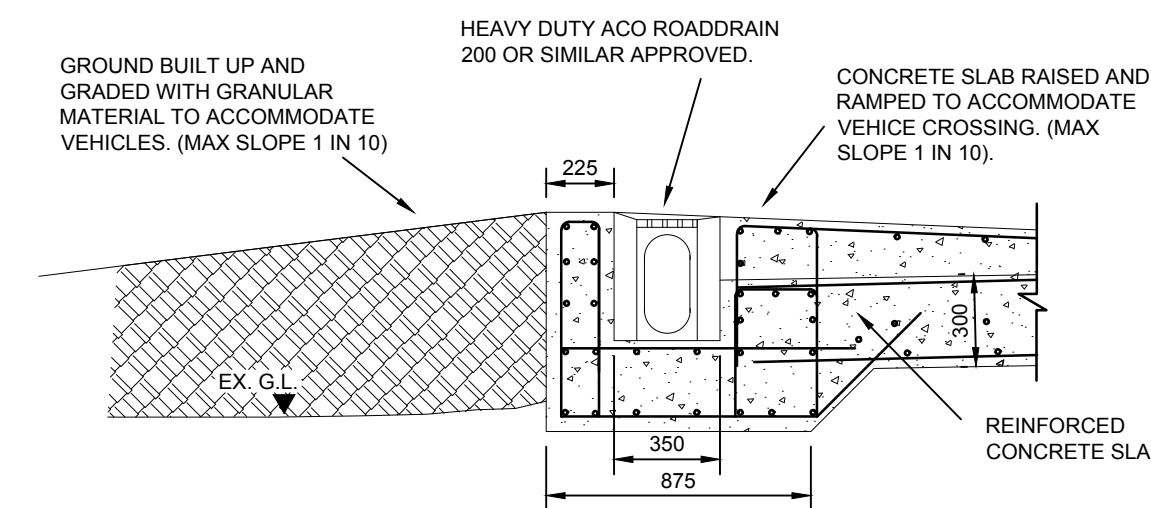

BIOMASS STORAGE SLAB B OPEN CHANNEL VEHICLE CROSSING DETAIL (TYP)
SCALE 1:25 (A1)

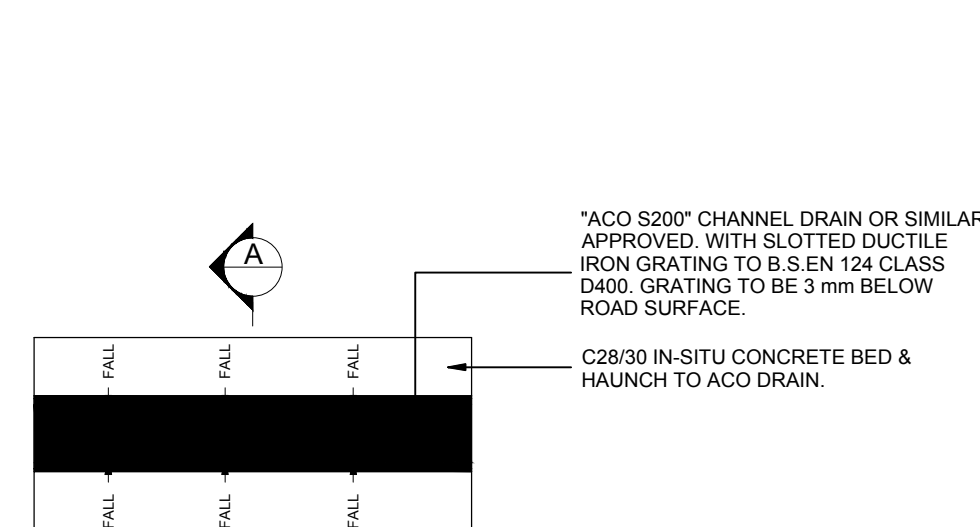

BIOMASS STORAGE SLAB A TYPICAL CHANNEL DRAIN - PLAN
NOTE: SUBJECT TO DETAILED DESIGN
SCALE 1:25 (A1)

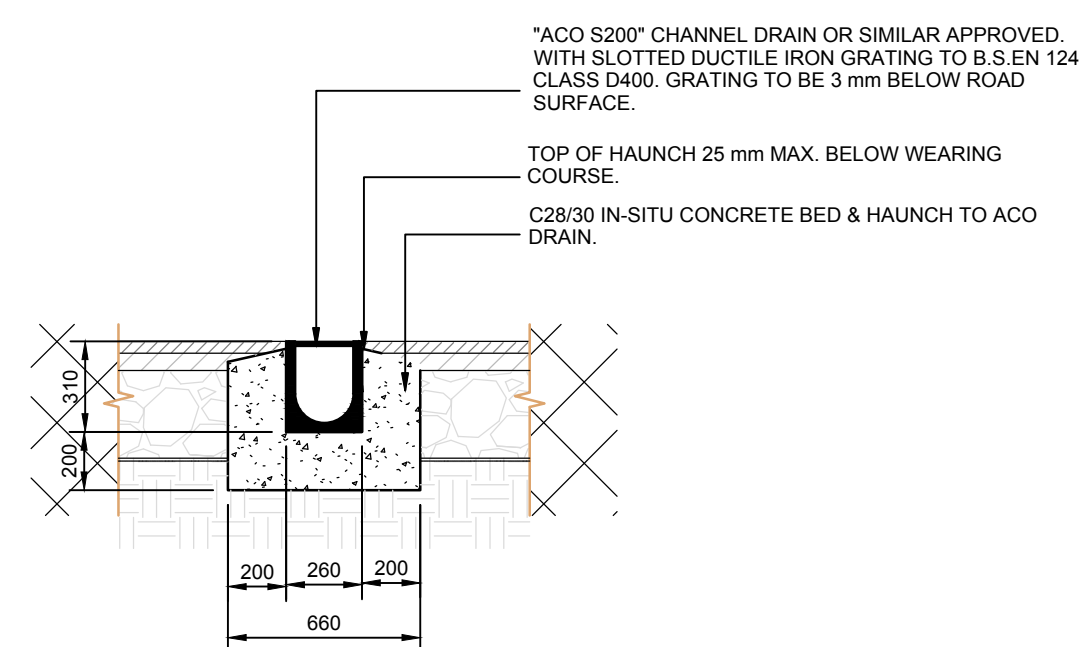

BIOMASS STORAGE SLAB A TYPICAL CHANNEL DRAIN - SECTION A-A
NOTE: SUBJECT TO DETAILED DESIGN
SCALE 1:25 (A1)

		ESBI	BNM					
0	18.10.18	ISSUED FOR PLANNING	HOK	PK	DK	PN	BH	
REV	DATE	REVISION DESCRIPTION	DRN	VER	APP	DRN	VER	APP
<p>COPYRIGHT © ESB INTERNATIONAL LIMITED ALL RIGHTS RESERVED. NO PART OF THIS WORK MAY BE MODIFIED, REPRODUCED OR COPIED IN ANY FORM OR BY ANY MEANS - GRAPHIC, ELECTRONIC OR MECHANICAL, INCLUDING PHOTOCOPYING, RECORDING, TAPING OR USED FOR ANY PURPOSE OTHER THAN ITS DESIGNATED PURPOSE, WITHOUT THE WRITTEN PERMISSION OF ESB ENGINEERING & FACILITY MANAGEMENT LTD., TRADING AS ESB INTERNATIONAL.</p> <p>PURPOSE OF ISSUE - PRELIMINARY UNLESS INDICATED</p> <p>CLIENT APPROVAL <input type="checkbox"/> PLANNING <input checked="" type="checkbox"/> TENDER <input type="checkbox"/> CONSTRUCTION <input type="checkbox"/> AS-BUILT <input type="checkbox"/></p> <p>CLIENT: ESB</p> <p>PROJECT: WEST OFFALY POWER TRANSITION TO BIOMASS</p> <p>ENGINEER DESIGN: One Dublin Airport Central, Dublin Airport, Cloughran, Co. Dublin. Tel: 353 1 703 8000 Email: marketing@esbi.ie Web: www.esbinternational.ie</p> <p>ENGINEER DESIGN: BORD na MÓNA Naturally Driven Engineering Department Leabeg, Tullamore, Co. Offaly Tel: 057 8345800</p> <p>CONTRACT: WOP - TRANSITION TO BIOMASS</p> <p>DRAWING TITLE: BIOMASS STORAGE SLAB B SECTION AND CONSTRUCTION DETAILS</p> <p>PRODUCTION UNIT: CIVIL & ENVIRONMENTAL ENGINEERING</p> <p>ESB INTERNATIONAL One Dublin Airport Central, Dublin Airport, Cloughran, Co. Dublin. Tel: 353 1 703 8000 Email: marketing@esbi.ie Web: www.esbinternational.ie</p> <p>ESB International is a trading name of ESB Engineering & Facility Management Ltd. Registered Office: as above. Registered in Ireland No. 155249</p>								
DRAWN	VERIFIED	APPROVED	APPROVAL DATE					
DK	H.O.K	PK	18.10.18					
CLIENT REF	NO. OF SHTS	SIZE	SCALE					
	1	A1	1:200					
DRAWING NUMBER							REV	
QS-000206-01-D460-072							0	